

# 9E Easy St. Suite 3

Bridgewater, NJ (GPS, Bound Brook)

6,000 SF AVAILABLE

## Availability:

- Total Building Size 29,750 sf
- Total Available: Approx 6,000 sf
- Office Area: Approx 550 sf

## Space Features:

- Loading Door: 1 (8' x 8')
- Drive-Ins: 1 (12' x 13'), 1 (8' x 8')
- Ceiling Ht: 14' clear
- Heat: Gas Hot Air
- Sprinkler: Fully (Wet System)
- Clear Span

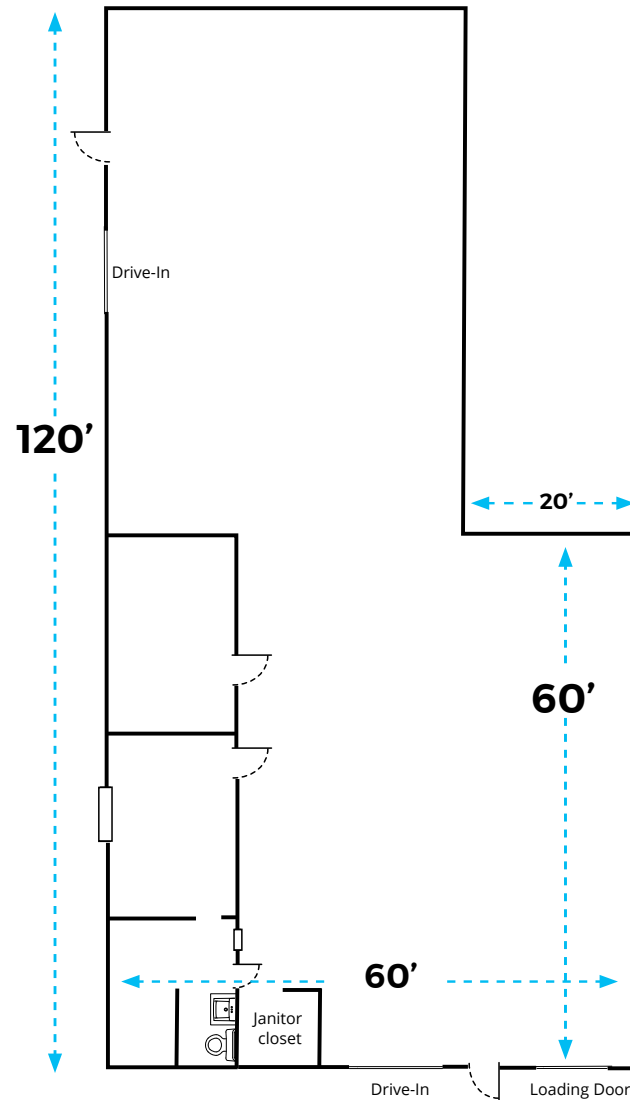

## LEASING INFORMATION:

**Jeffrey Furey**

973.947.9242

Jeffrey.Furey@transwestern.com

The information provided herein was obtained from sources believed reliable; however, Transwestern makes no guarantees, warranties or representations as to the completeness of accuracy thereof. The presentation of this property is submitted subject to errors, omissions, change of price or conditions, prior to sale or lease, or withdrawal without notice. Copyright © 2021 Transwestern.

\*Floorplan not to exact scale